



29/277 Kingsway Caringbah NSW

2 2 2

Occupying a top floor position within the prestige Nirvana complex, this spectacular two bedroom apartment boasts a sun drenched northern aspect and panoramic views over Botany Bay and the City skyline.

Price : \$ 897,500

View : <https://www.gibsonpartners.com/sale/nsw/sutherland/caringbah/residential/apartment/5853752>

Providing an exceptional sense of natural lighting, the deluxe open plan layout offers a relaxed, secure and low maintenance lifestyle.

Stylishly designed with many hidden extras, double lock-up garaging and lift access to the front door, this exceptional property is just seconds to the local cafes, clubs, restaurants, shops and transport.

- Stunning views over Botany Bay and across to the City skyline



Ivan Lampret
02 9523 1333



Karla Madgwick
02 9523 1333

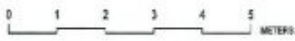
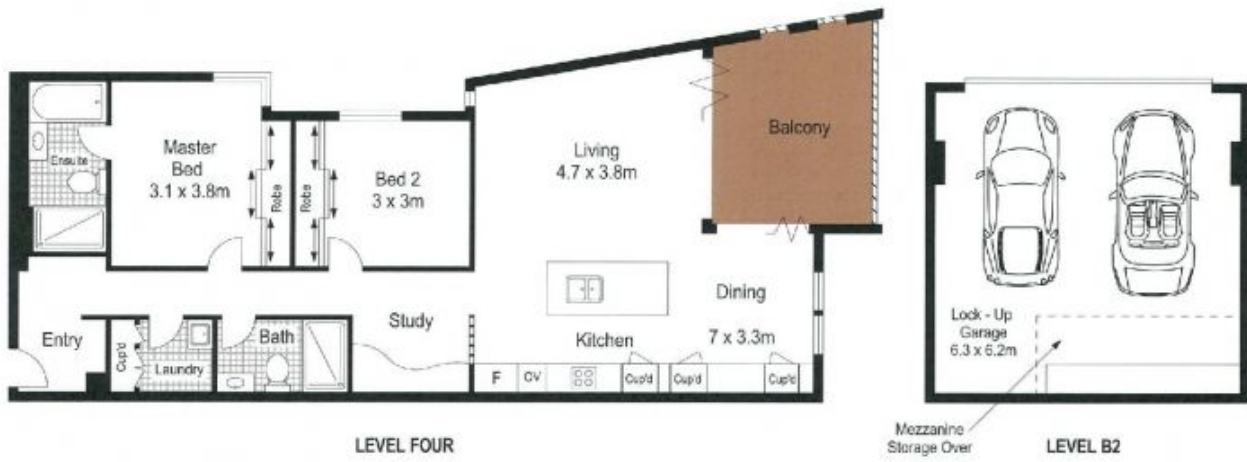

Scale in metres, indicative only. Dimensions are approximate. All information contained herein is gathered from sources we believe to be reliable. However we cannot guarantee its accuracy and interested persons should rely on their own enquiries.

29/277 Kingsway, Caringbah