



23A Castelnau Street Caringbah South NSW

3 2 2

Boasting a prized northerly rear yard, this contemporary home has all the trappings to support a comfortable lifestyle all year round and is designed to provide open plan living spaces and a great entertainers' layout.

This well maintained duplex presents a perfect combination of low maintenance living with a convenient location within walking distance to Castelnau Park Reserve, local schools, shops and cafes.

- Immaculate duplex, flexible floor plan with scope for additional garage
- Open plan kitchen with gas cooktop, s/s appliances & breakfast bar
- Home office, high ceilings, reverse cycle A/C, timber floor boards

Price : \$ 1,140,000

View : <https://www.gibsonpartners.com/sale/nsw/sutherland/caringbah-south/residential/semi-detached/5853777>

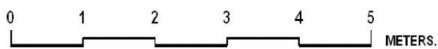
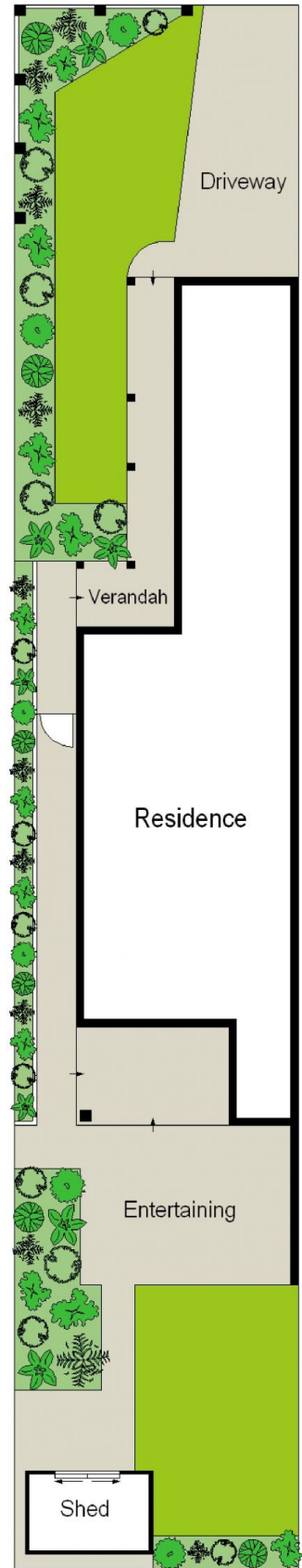
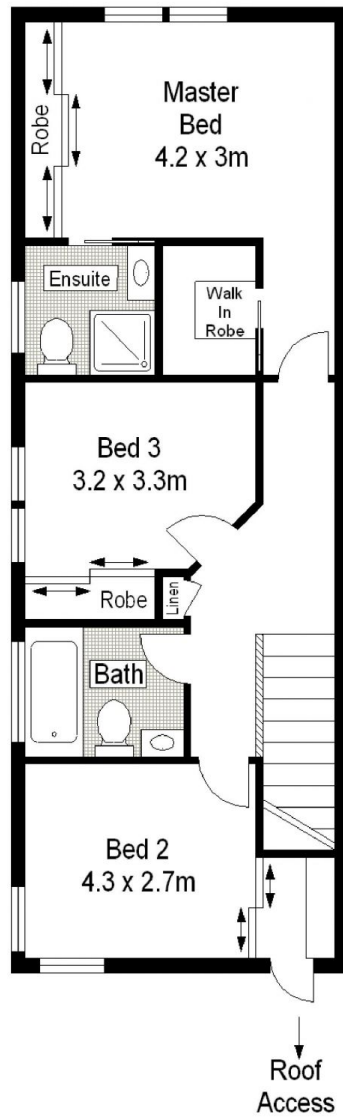
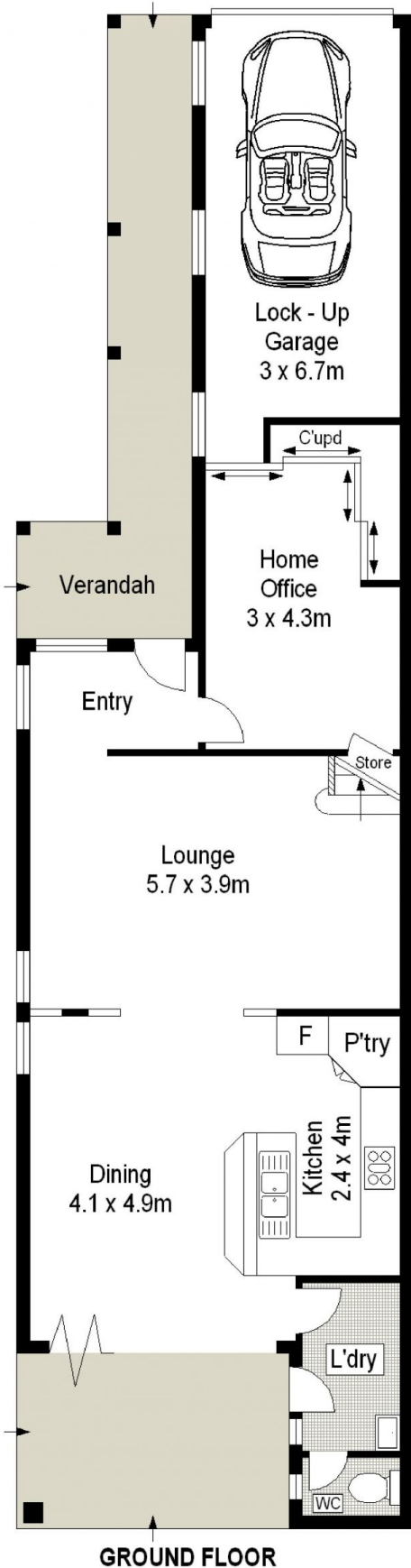

Gibson Partners Real Estate Pty Ltd

Scale in metres. Indicative only. Dimensions are approximate. All information contained herein is gathered from sources we believe to be reliable. However we cannot guarantee its accuracy and interested persons should rely on their own enquiries.



23A Castelnau Street, Caringbah South

GIBSON