



510/296 Kingsway Caringbah NSW

2 2 1

Centrally located, this spacious modern two bedroom apartment boasts a sun drenched northern aspect and panoramic views over Botany Bay and the City skyline.

Boasting an exceptional sense of natural light, the expansive open plan layout leads to bi-fold doors and balcony. Offering a relaxed, secure and low maintenance lifestyle this exceptional property is just footsteps to the local cafes, clubs, restaurants, shops and transport.

- Glorious panoramic views over Botany Bay & the City skyline
- Open plan interiors, bi-fold doors leading to Nth facing balcony
- Modern kitchen with stainless steel appliances & gas cooktop

Price : \$ 573,000

View : <https://www.gibsonpartners.com/sale/nsw/sutherland/caringbah/residential/apartment/5853861>



Ivan Lampret
02 9523 1333



Karla Madgwick
02 9523 1333

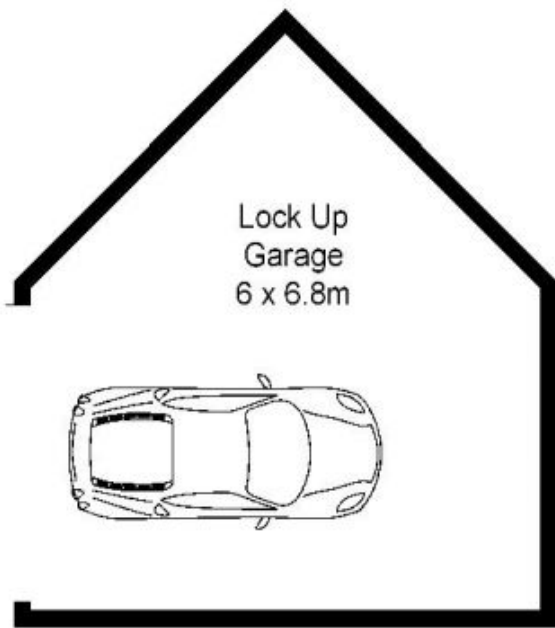

LOWER BASEMENT

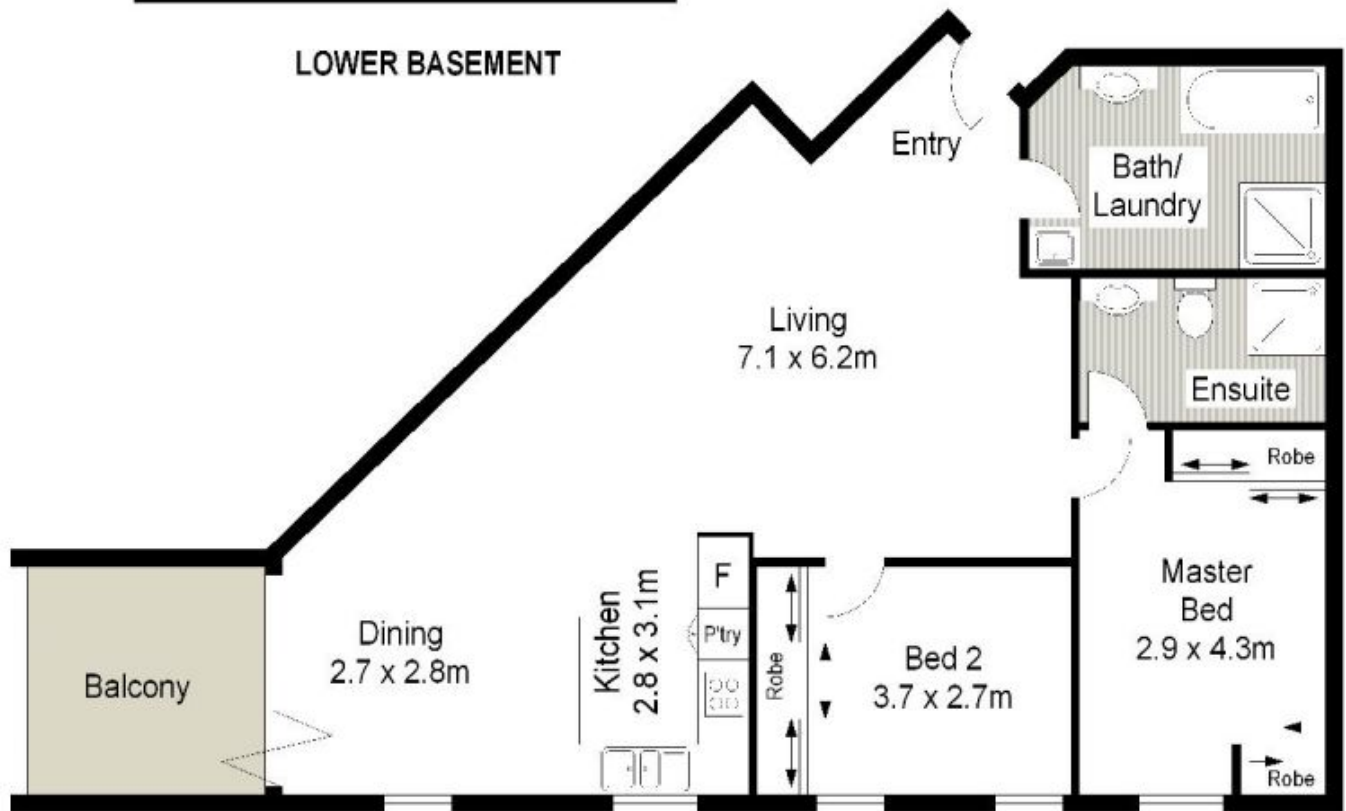

LEVEL FIVE

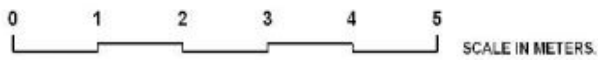

Gibson Partners Real Estate Pty Ltd

Scale in metres. The above only if the dimensions are approximate. All information contained herein is gathered from sources we believe to be reliable, however we cannot guarantee its accuracy and interested persons should rely on their own enquiries.



510/296 Kingsway Caringbah

GIBSON