



7/35 Girrillang Road Cronulla NSW

1 1 1

Ground floor apartment with registered car space
Open plan interiors with original kitchen & bathroom
Good size bedroom, high ceilings, linen press
Shared laundry facilities, security building with intercom entry
Located in a quiet block of only seven.
Easy stroll to beaches, restaurants, cafes, shops & transport

View : <https://www.gibsonpartners.com/lease/nsw/sutherland/cronulla/residential/unit/5853954>

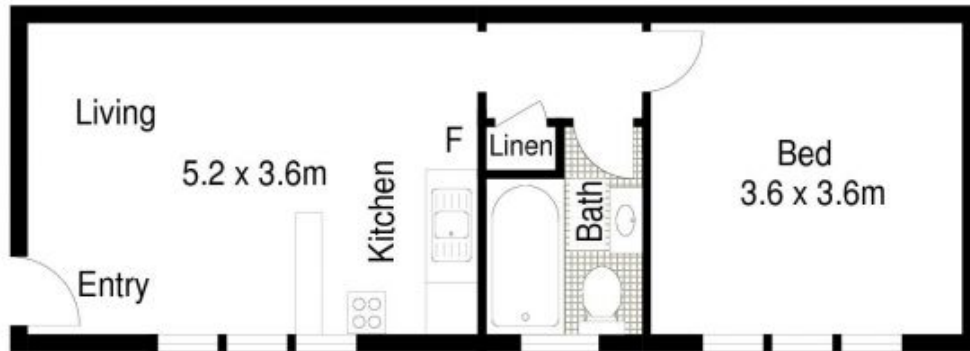
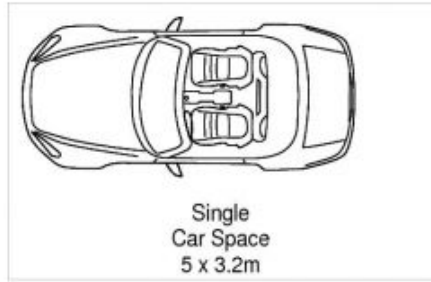

GROUND FLOOR

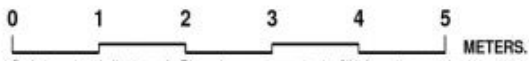

Scale in metres. Indicative only. Dimensions are approximate. All information contained herein is gathered from sources we believe to be reliable. However we cannot guarantee its accuracy and interested persons should rely on their own enquiries.



7/35 Girilang Road, Cronulla

