



4/1-7 Clyde Avenue Cronulla NSW

1 1 1

This apartment offers an extremely rare opportunity for fast moving first home buyers to secure a large and well-designed living space in South Cronulla's most convenient location with style to match.

First time offered since new in 2001 this spacious and elevated one bedroom apartment is situated on the ground floor and is in near perfect condition and located in a quiet cut de sac, within only a five minute walk to Cronulla Train Station, cafes and your favourite shops and restaurants.

- Modern full security building with intercom & lift access from basement
- Spacious living room with accompanying sunny west facing balcony
- Ultra functional kitchen, granite bench tops, Smeg

Price : \$ 800,000

View : <https://www.gibsonpartners.com/sale/nsw/sutherland/cronulla/residential/apartment/5854292>



Justin Buck
02 9523 1333

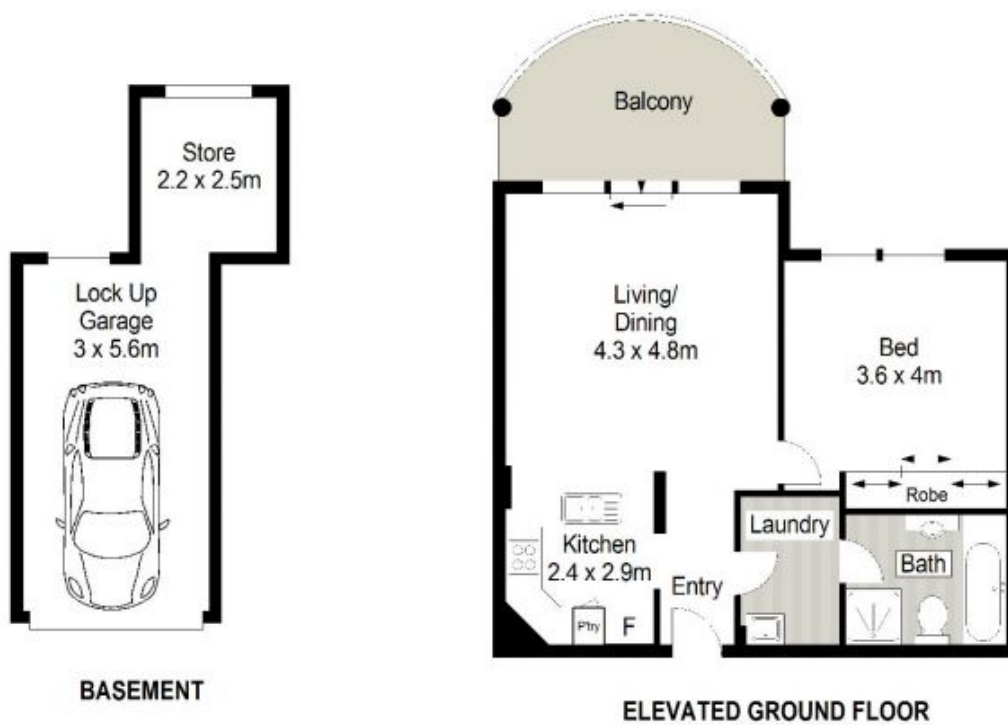

0 1 2 3 4 5 SCALE IN METRES.

Gibson Partners Real Estate Pty Ltd

Scale in metres. Indicated only. Dimensions are approximate. All information contained herein is gathered from sources we believe to be reliable. However, we do not warrant, represent or guarantee the accuracy and information provided should rely on that with care.



4/1 Clyde Avenue, Cronulla South

GIBSON