



9/52 Kingsway Cronulla NSW

2 2 2

This spacious North facing two bedroom apartment is immaculately presented throughout with large open plan interiors and enjoys a convenient location just a leisurely stroll to Cronulla's beaches, shops, restaurants & transport.

View : <https://www.gibsonpartners.com/lease/nsw/sutherland/cronulla/residential/apartment/5854306>

Features include,
Spacious lounge/dining leads to sunny north facing balcony
Open plan kitchen with granite benches, s/s appliances & gas cook-top
Generous master bedroom with walk in robe & ensuite
Sunny second bedroom with access to balcony and wardrobe
Fully tiled bathroom with separate bath & shower
Split system air- conditioner, internal laundry & linen cupboard
Security block with intercom entry & lift access



Amber Dare
02 9523 1333



Emily Musumeci
02 9523 1333

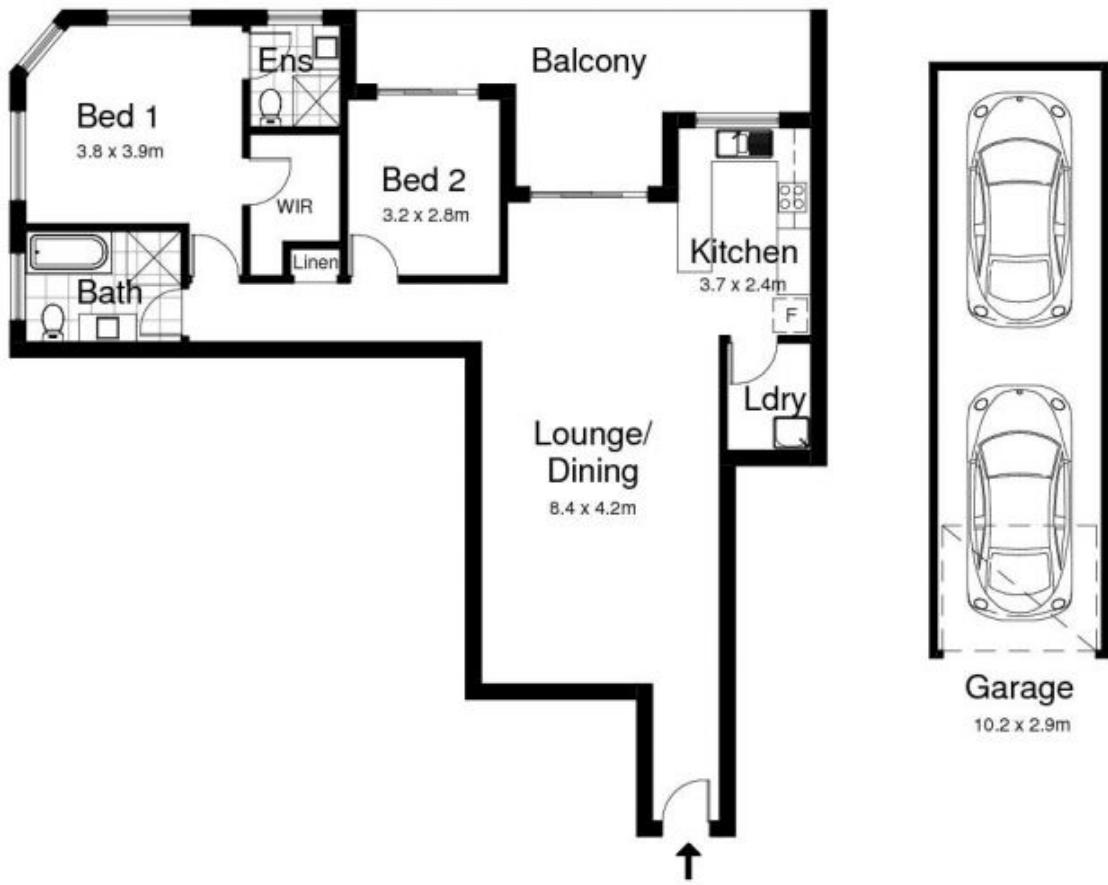

9/52 Kingsway, CRONULLA

DISCLAIMER: All care has been taken in preparing this floorplan, however the accuracy is not guaranteed and no liability will be accepted for any reliance placed upon it
Produced by PRODUCT PHOTOGRAPHY STUDIO mob: 0414 697 215 email: mgphoto@people.net.au