



35A Woodward Avenue Caringbah South NSW

5 2 2

Positioned in a private setting at the rear of the block, this impressive Torrens Title home boasts a sunny northerly aspect and stretches over two generous levels, offering multiple entertaining spaces and exceptional outdoor alfresco area overlooking manicured gardens and sparkling in-ground pool.

Beyond the prominent façade lies a superb fusion of space, style and quality. Located in a sought-after cul-de-sac setting and positioned within close proximity to a selection of local schools, shops, cafes and parks.

- Formal & informal living & dining rooms, two with open fireplace
- Crisp hostess kitchen with Caesarstone benchtops & s/s appliances

Land Size : 678.9 sqm
View : <https://www.gibsonpartners.com/sale/nsw/sutherland/caringbah-south/residential/house/5854575>



Ivan Lampret
02 9523 1333



Briolynn Kennedy
02 9523 1333

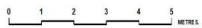
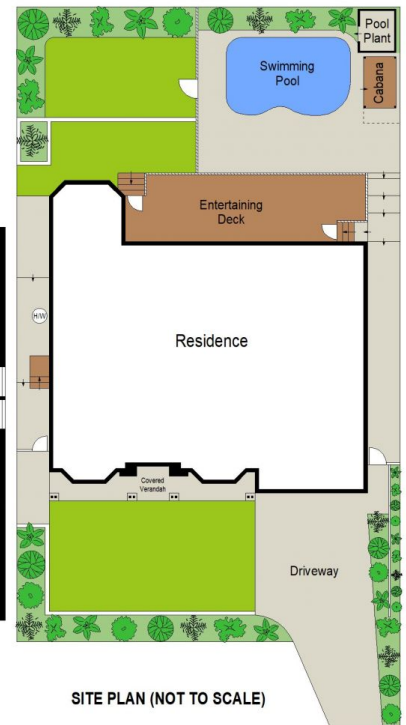
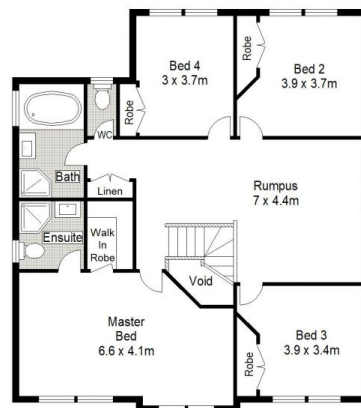

Gibson Partners Real Estate Pty Ltd

Scale in metres. Indicative only. Dimensions are approximate. All information contained herein is gathered from sources we believe to be reliable. However we cannot guarantee its accuracy and interested persons should rely on their own enquiries.



35A Woodward Avenue, Caringbah South

GIBSON