



1/81 Yathong Road Caringbah NSW

3 2 2

Well-proportioned and flowing over two levels, this spacious Townhouse set amongst beautiful lush gardens is tailored to provide an effortless family lifestyle of space, comfort and relaxed outdoor entertaining.

Price : \$ 850,000

View : <https://www.gibsonpartners.com/sale/nsw/sutherland/caringbah/residential/townhouse/5854610>

One of only three in a boutique complex and positioned in a highly convenient location within easy reach of all local amenities, including primary and secondary schools, Caringbah Leisure Centre, shops, cafes and transport options, this home will appeal to an assortment of buyers.

- Large combined sunken lounge & dining with A/C
- Modern kitchen fitted with s/steel appliances
- Three bedrooms, BIR's, main with ensuite & WIR
- Two bathrooms, internal laundry & powder room
- Entertaining deck, lush gardens & private courtyard



Denise Howell
02 9523 1333

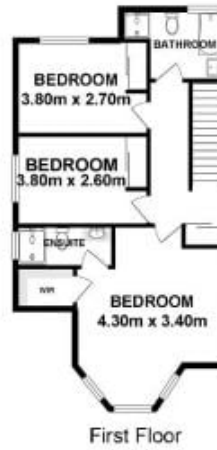
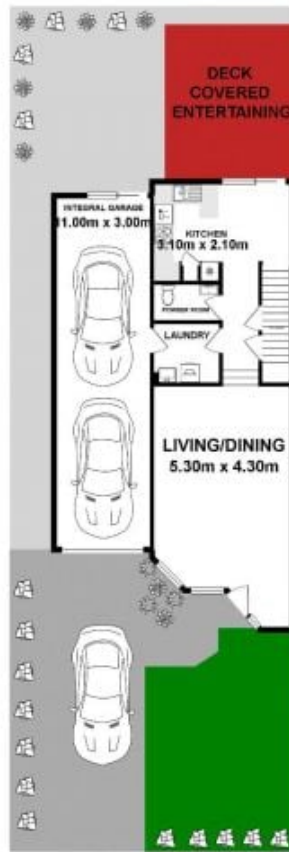

Gibson Partners Real Estate Pty Ltd

Scale is for information only. Dimensions are approximate and based on the information provided. The information is provided for general information only and should not be relied upon for any specific purpose. The information is provided for general information only and should not be relied upon for any specific purpose.



1/81 Yathong Road, Caringbah

GIBSON