



298 President Avenue Gymea NSW

4 1 4

Immaculately presented throughout and set on a sizeable 714sqm block, this family home is ideal for young growing families seeking space and convenience, with local schools, shops and transport just minutes away.

Land Size : 714 sqm

View : <https://www.gibsonpartners.com/sale/nsw/sutherland/gymea/residential/house/5854723>

Featuring four bedrooms, a separate living and dining room and an enormous backyard offering the savvy renovators a chance to open up and reconfigure the floorplan or even extend the home out (STCA).

- Separate living & dining rooms with air-conditioning
- Four bedrooms, two fitted with built-in wardrobes
- Neat open kitchen features stainless steel appliances
- Stylish bathroom, internal laundry, rumpus room or office
- Entertaining alfresco deck & level pet/child-friendly backyard



Chris Walsh
02 9523 1333

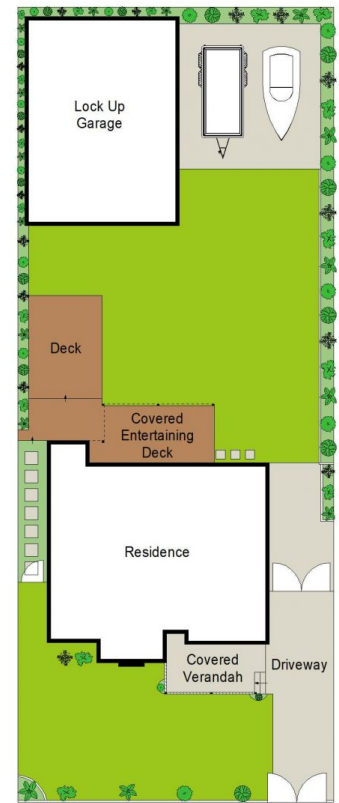
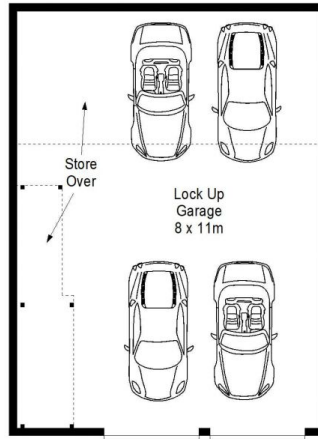

SITE PLAN (NOT TO SCALE)



0 1 2 3 4 5 METRES.

Gibson Partners Real Estate Pty Ltd

Scale in metres. Indicative only. Dimensions are approximate. All information contained herein is gathered from sources we believe to be reliable. However we cannot guarantee its accuracy and interested persons should rely on their own enquiries.

298 President Avenue, Gymea

GIBSON