



479 Willarong Road Caringbah South NSW

3 3 2

Capturing expansive views across the glistening waters of Yowie Bay and bathed in a warm westerly aspect, this immaculate family residence is truly unique. Offering a versatile floorplan, high ceilings, polished hardwood timber floors, wrap around entertaining balcony and expansive living spaces that are framed in glass filling each space with natural light and uninterrupted views.

Occupying a substantial 758sqm (approx.) of land, this solid brick residence is privately tucked away in a tightly held peaceful position on the Caringbah South peninsula yet provides easy access to local schools, shops, cafes and transport.

- Free flowing interiors open to balcony with picturesque views

Land Size : 758.8 sqm

View : <https://www.gibsonpartners.com/sale/nsw/sutherland/caringbah-south/residential/house/6333321>



Ivan Lampret
02 9523 1333



Karla Madgwick
02 9523 1333

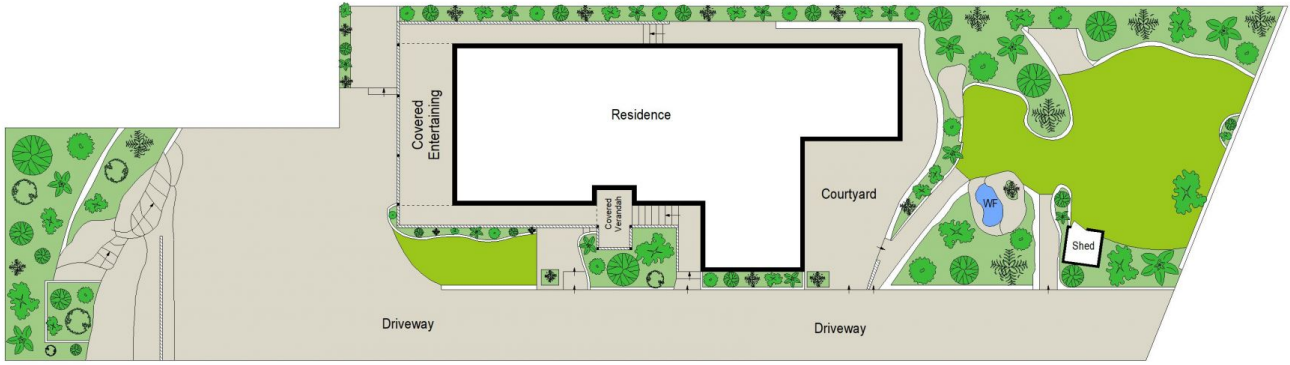

SITE PLAN (NOT TO SCALE)

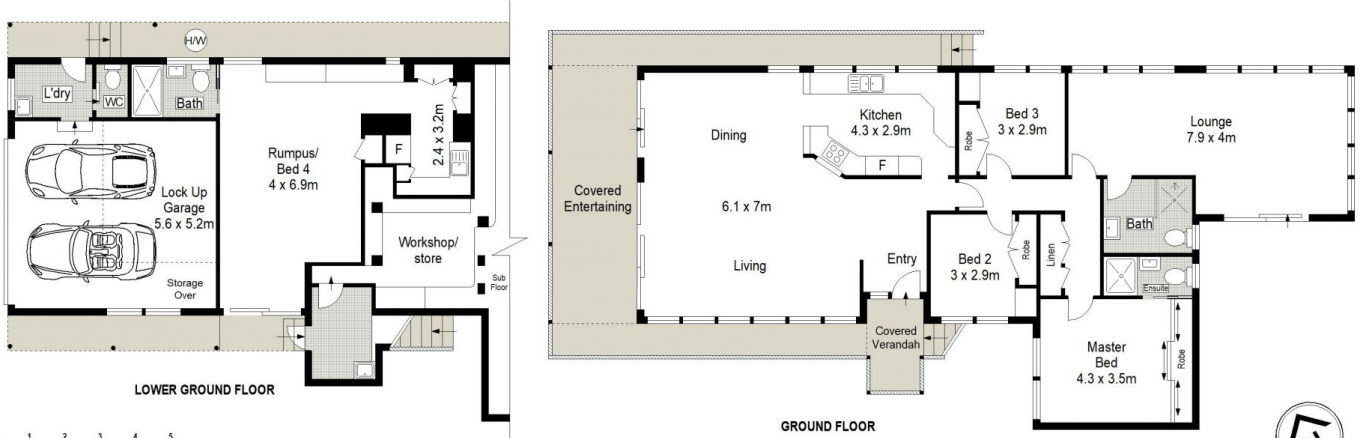

LOWER GROUND FLOOR

GROUND FLOOR

0 1 2 3 4 5 METRES

Gibson Partners Real Estate Pty Ltd

Scale in metres. Indicative only. Dimensions are approximate. All information contained herein is gathered from sources we believe to be reliable. However we cannot guarantee its accuracy and interested persons should rely on their own enquiries.



479 Willarong Road, Caringbah South

GIBSON