



## 410/296-300 Kingsway Caringbah NSW

2 2 1

Boasting an exceptional light-filled and expansive open plan layout this two bedroom apartment boasts a sundrenched northerly aspect with views over Botany Bay and the City skyline.

**View :** <https://www.gibsonpartners.com/sale/nsw/sutherland/caringbah/residential/apartment/6551419>

Offering a relaxed, secure and low-maintenance lifestyle this apartment is centrally located and convenient to local cafes, clubs, restaurants, shops and transport.

- Open-plan interiors, bi-fold doors leading to Nth facing balcony
- Modern kitchen with stainless steel appliances & gas cooktop
- 2 good size carpeted bedrooms with built in robes, main with ensuite
- Spacious bathroom with laundry, timber flooring,



**Chris Walsh**  
02 9523 1333

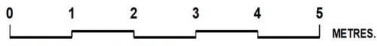
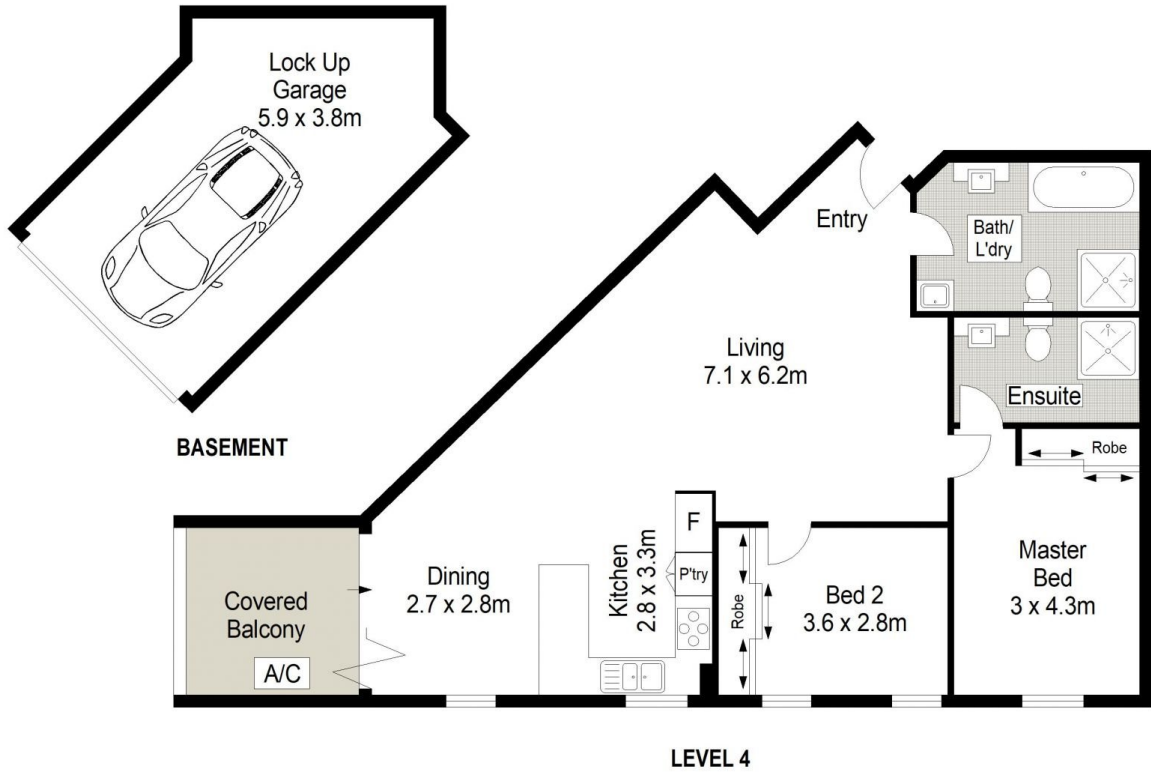

Gibson Partners Real Estate Pty Ltd

Scale in metres. Indicative only. Dimensions are approximate. All information contained herein is gathered from sources we believe to be reliable. However we cannot guarantee its accuracy and interested persons should rely on their own enquiries.



410/296 Kingsway, Caringbah

**GIBSON**