



12/694-698 Kingsway Gymea NSW

3 1 2

Quietly positioned to the rear of a security complex, this stylishly presented townhouse is the perfect opportunity for first home buyers, investors and downsizers. Within a convenient short stroll to Westfield Miranda shopping, Gymea Village, transport and a bustling array of eateries, retail options and amenities.

**View** : <https://www.gibsonpartners.com/sale/nsw/sutherland/gymea/residential/townhouse/6574372>

Offering spacious light-filled living areas spanning across three levels showcasing a stylish, well-designed kitchen with gas cooking, fully renovated bathroom and two low-maintenance courtyards, a covered alfresco dining area, and secure basement double lock-up garage with internal access.



**Chris Walsh**  
02 9523 1333

- Open-plan living & dining with beautifully tiled flooring
- Modern kitchen with gas cook top, s/steel appliances

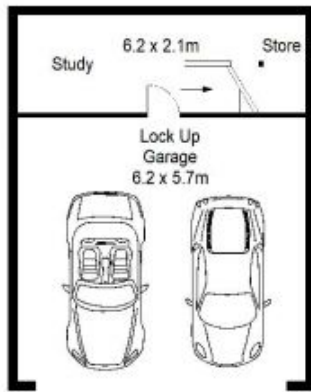

**BASEMENT**



**GROUND FLOOR**

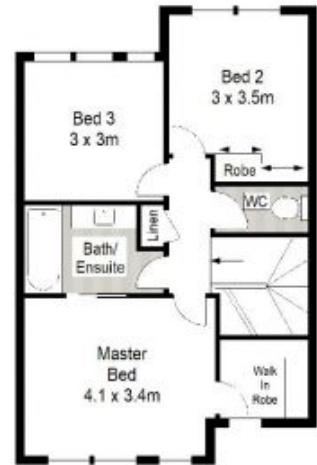

**FIRST FLOOR**

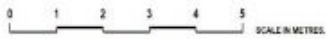

Gibson Partners Real Estate Pty Ltd

Scale in metres. Indicated only. Dimensions are approximate. All information contained herein is for general information only and does not constitute a contract. Please refer to the contract documents for the actual details. Information provided should not be relied upon without verification.



12/694 Kingsway, Gymea

**GIBSON**