



## 342 President Avenue Gymea NSW

3 2 4

Appealing to an array of purchasers including first home buyers, investors, down sizers or even business owners, this low maintenance home with no strata fees, presents a unique opportunity to obtain a free-standing family residence in the highly sort after suburb of Gymea positioned within 400m to the centre of village shops and train station.

Retaining abundant character with its 9ft ceilings, polished hardwood timber flooring and light filled northerly aspect, there is also further scope to update and personalise to your own taste.

- Free standing low maintenance home with no ongoing strata fees
- Super convenient location minutes to Gymea shops and

**Price** : \$1,100,000 - \$1,200,000

**Land Size** : 314 sqm

**View** : <https://www.gibsonpartners.com/sale/nsw/sutherland/gymea/residential/house/6970910>



**Ivan Lampret**  
02 9523 1333



**Karla Madgwick**  
02 9523 1333

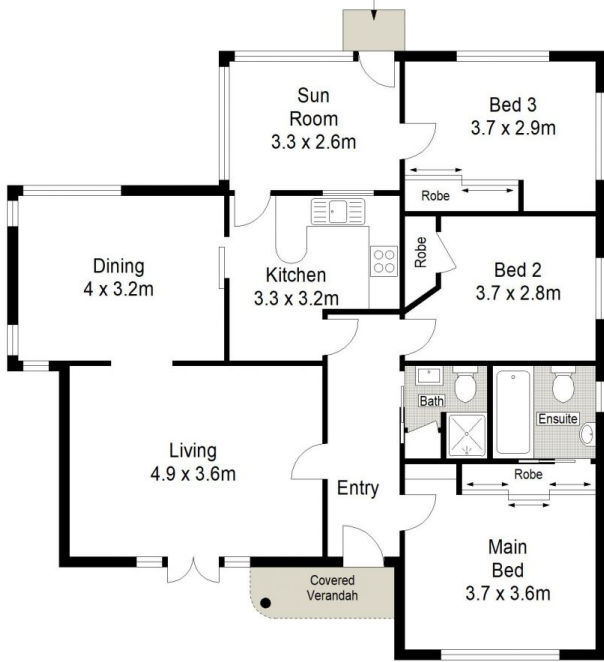

SITE PLAN (NOT TO SCALE)



0 1 2 3 4 5 METRES.

Gibson Partners Real Estate Pty Ltd

Scale in metres. Indicative only. Dimensions are approximate. All information contained herein is gathered from sources we believe to be reliable. However we cannot guarantee its accuracy and interested persons should rely on their own enquiries.

342 President Avenue, Gymea

**GIBSON**