



6/38 Nicholson Parade Cronulla NSW

4 2 2

Positioned perfectly in the South Cronulla peninsula, this four bedroom apartment offers house-like proportions, glistening bay views and is nearby to Gunnamatta Bay, Cronulla mall and Cronulla beach.

- Kitchen with stainless steel oven, dishwasher
- Combined lounge/dining area leads to balcony
- ? Master bedroom with walk-in robe and ensuite
- ? Three good sized bedrooms, one with mirrored built in robe
- Fully tiled bathroom with separate bath and shower
- ? Tandem lock-up garage with storage
- ? Security intercom, only 8 apartments in complex

Please register for inspections via 'Book Inspection' or 'Email Agent' buttons.

View : <https://www.gibsonpartners.com/lease/nsw/sutherland/cronulla/residential/apartment/7643120>



Joseph Guerzoni
02 9523 1333

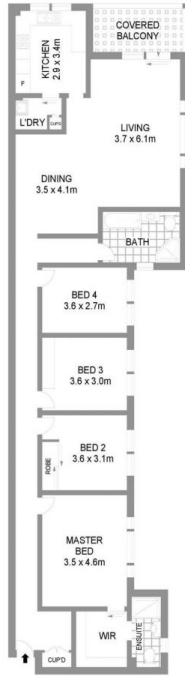

LEVEL TWO

(FRIDGE - 0.71m WIDTH x 0.606m DEPTH x 1.70m HEIGHT)
 6/38 Nicholson Parade



LEVEL ONE

Cronulla