



View from balcony

16/277-281 Kingsway Caringbah NSW

2 2 1

Occupying the third level within the prestige Nirvana complex, this spectacular two bedroom apartment boasts a sun drenched northern aspect and scenic views over Botany Bay and the City skyline.

View : <https://www.gibsonpartners.com/sale/nsw/sutherland/caringbah/residential/apartment/7865439>

Stylishly designed and providing lift access to your door, this exceptional apartment offers a relaxed, secure and low maintenance lifestyle convenient to the local cafes, clubs, restaurants, shops and transport.

- Occupies the third level with a desirable northern aspect
- Scenic views over Botany Bay and the City skyline
- Spacious lounge and dining area, split system AC
- Open plan stone island kitchen with gas cook-top
- Good size dedicated study nook adjoins the kitchen
- Two large bedrooms with BIRs and ensuite to main



Ivan Lampret
02 9523 1333



Karla Madgwick
02 9523 1333

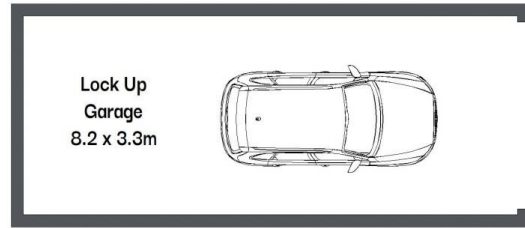

BASEMENT LEVEL

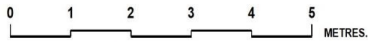
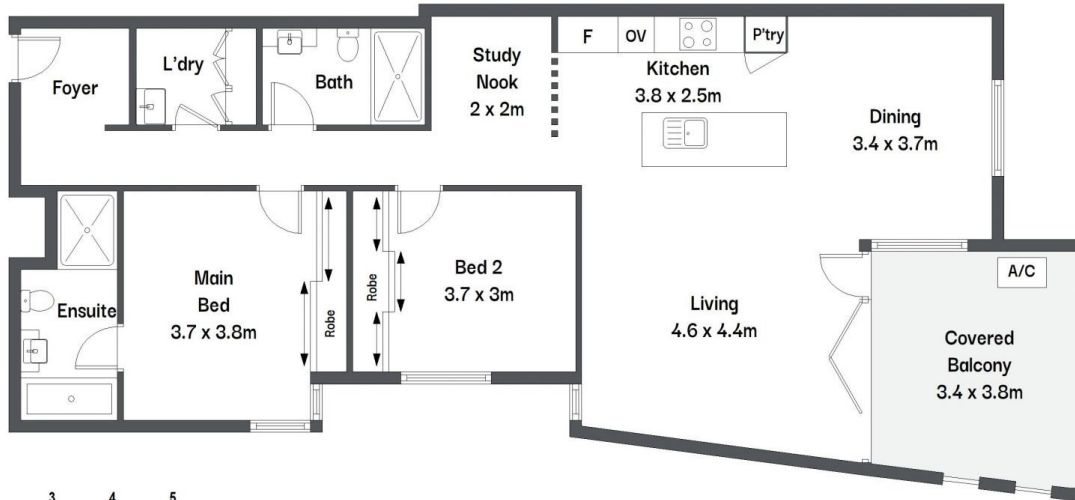

Gibson Partners Real Estate Pty Ltd

FLOOR PLAN ON DEMAND Scale in metres. Indicative only. Dimensions are approximate. All information contained herein is gathered from sources we believe to be reliable. However we cannot guarantee its accuracy and interested persons should rely on their own enquiries.



16/277 Kingsway, Caringbah

GIBSON