



14 Loraine Avenue Caringbah South NSW

3 1 2

Presented for the first time since built by the original owners in 1955, this superbly cared for and much-loved family home presents the perfect opportunity for young families looking to enter the market or those with a creative vision to renovate or rebuild the next cutting edge architecturally designed dream home (STCA).

Situated on approximately 580sqm and providing easy access to local waterways, within 650m to Caringbah Public School, and convenient to local cafes, shops, parks and transport, this unique land holding provides opportunity and tremendous potential to further capitalise.

- Original home in a peaceful street with scope to capitalise
- Spacious living area opens onto generous front balcony

Price : \$ 1,816,500

Land Size : 594 sqm

View : <https://www.gibsonpartners.com/sale/nsw/utherland/caringbah-south/residential/house/7903036>



Ivan Lampret
02 9523 1333



Karla Madgwick
02 9523 1333

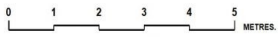
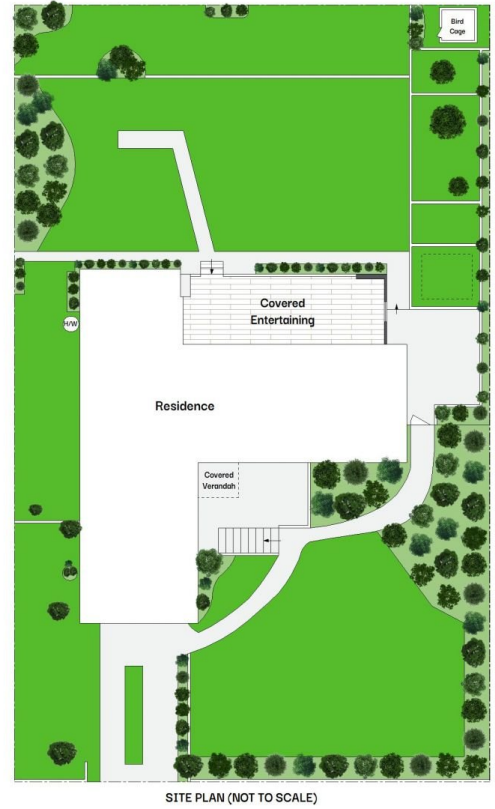

Gibson Partners Real Estate Pty Ltd

FLOOR PLAN ON DEMAND Scale in metres. Indicative only. Dimensions are approximate. All information contained herein is gathered from sources we believe to be reliable. However we cannot guarantee its accuracy and interested persons should rely on their own enquiries.



14 Loraine Avenue, Caringbah South

GIBSON