



55 Woodfield Boulevard Caringbah NSW

3 2 4

Providing the perfect lifestyle package for young families or downsizing empty nesters with all the hard work already done, this beautiful owner builder's home showcases an abundance of comfort, privacy and flexibility in a sought-after locale. Warm and welcoming upon entry with a seaside aesthetic, the presentation is immaculate. The desirably sunny west facing rear yard, versatile single level layout, soaring ceilings, solid Blackbutt timber floors, and effortless flow to the all-weather alfresco entertaining area and private backyard create a peaceful sanctuary that is ready for immediate enjoyment.

Complimented by landscaped surrounds and centrally placed with a Caringbah address convenient to selective schools, sporting fields, transport and also provides easy access to Cronulla's wonderful beaches and the City

Price : \$ 1,700,000
Land Size : 645 sqm
View : <https://www.gibsonpartners.com/sale/nsw/sutherland/caringbah/residential/house/7963185>



Farrah Tidmarsh
02 9523 1333



Ivan Lampret
02 9523 1333

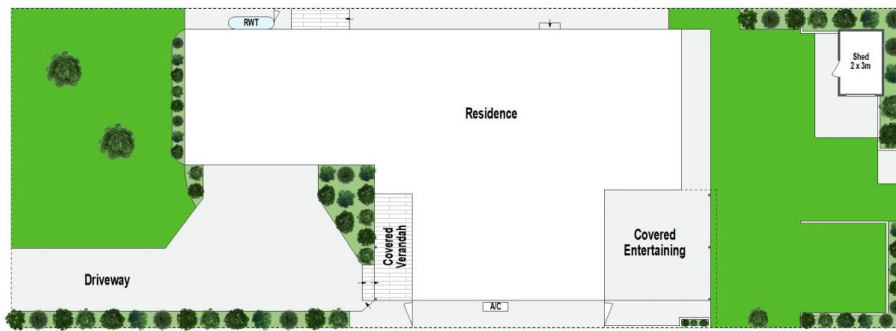

SITE PLAN (NOT TO SCALE)



0 1 2 3 4 5 METRES

Gibson Partners Real Estate Pty Ltd

FLOOR PLAN ON DEMAND Scale in metres. Indicative only. Dimensions are approximate. All information contained herein is gathered from sources we believe to be reliable. However we cannot guarantee its accuracy and interested persons should rely on their own enquiries.



GIBSON